

CONFIDENTIAL

Copy No.....

1 ATF
NUI DAT
231800H Apr 68
Sigs 102

SIG INSTR 3/68 (OP TOAN THANG)

Time Zone used throughout this instr: HOTEL

General

1. All comms facilities currently existing in the NUI DAT base area will continue. Additional facilities to be provided for the Op are detailed in this instr.
2. 1 ATF SOIs for Apr 68 apply. SOIs for May become effective 010001 May 68.
3. General comms facilities for the Op are shown at Annex A.

Radio

4. 1 ATF Comd Net (VHF) Current:
 - a. Ref 1 ATF SOI Item No 8, Apr 68, add step Up stn - Callsign 99.
 - b. Callsign 99 is to join the net at 240750 Apr 68.
 - c. Callsign 99 will revert to NCS of 1 ATF Comd Net Fwd (VHF) with new callsign 16 from BEARCAT on order of G2 (Ops).
5. 1 ATF Comd Net Fwd (VHF). Annex B.
6. 1 ATF Comd Net Rear (VHF):
 - a. See Annex C.
 - b. To be established 5 mins after 1 ATF Comd Net Fwd is estb. During this time all substas on this net are to remain on the operating freq and await instrs from NCS.
7. Misc Radio Nets:
 - a. 1 ATF TG link (HF Back up)
 - b. Air Task Net
 - c. Unit Nets

} Annex D

Radio Relay

8. 104 Sig Sqn has under comd for the Op 2 x AN/MRC-69 shelters which will provide direct comms between 1 ATF Main and 1 ATF Rear. Channel allocation is shown at Annex E.
Signal Centre
9. Channel space has been provided by US Sigs Units and is shown at Annex E.
10. 104 Sig Sqn will provide a Fwd Sigcen at BEARCAT operati
151200 Apr 68.

CONFIDENTIAL

CONFIDENTIAL

- 2 -

11. 1 ATF Sigcen NUI DAT - no change.

Line

12. 104 Sig Sen line det will lay line as required in the
1 ATF Main loc.

13. Trunk diag shown at Annex A.

Swbd

14. EBONY Fwd Swbd will be estb at BEARCAT operating from
251200 Apr 68. Locals to EBONY Fwd are to serve as 1 ATF Fwd
Telephone Directory and is shown at Annex F. Supplements to
tele directory will be issued in loc as aval.

15. Exchange diag shown at Annex A.

Msg Carrying Agencies

16. SDS, ADS and Air Courier time tables will be issued in
loc BEARCAT. Annex A indicates proposed service.

J. N. C. Munro
(N.C. MUNRO)
Maj
Sig Offr

CONFIDENTIAL

ARRIVAL 1 2 1
SIC 3/68

RADIO RELAY NET

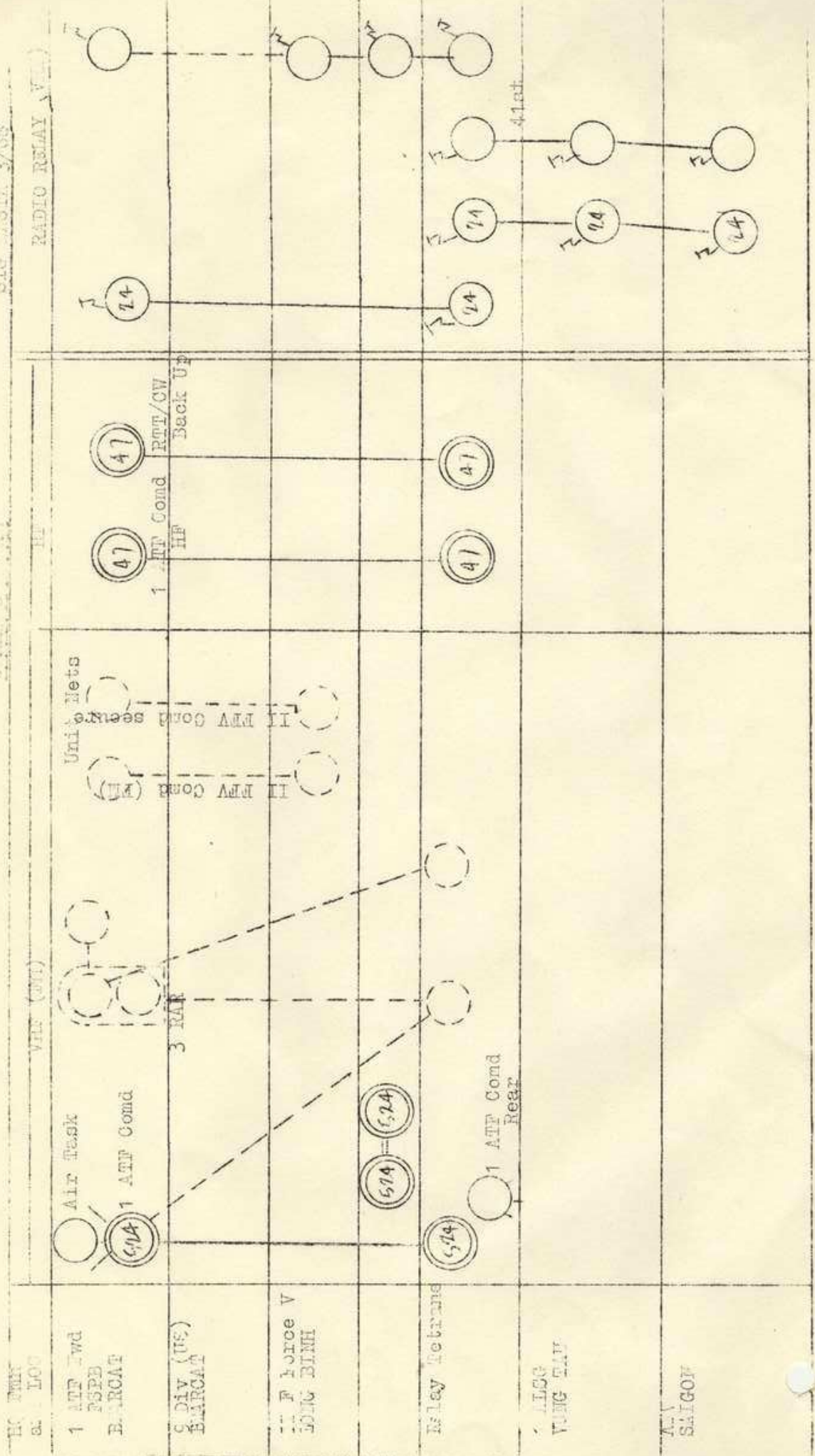

ANNEX A 2.2 TO 1 AMP
 SEC 133A 3/88

JOINT DISTRIBUTION
 DATE 03/08/88

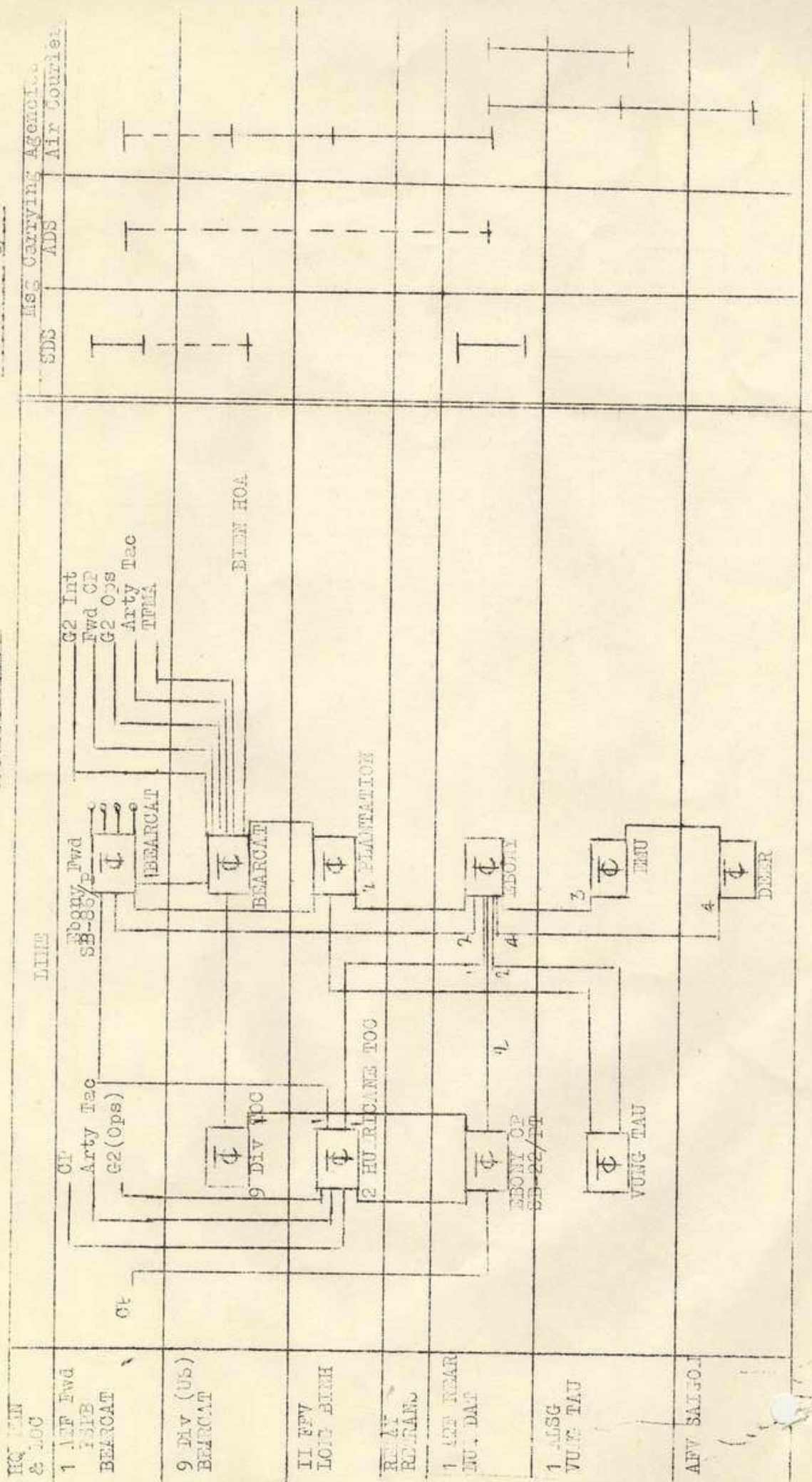

ANNEX B to 1 ATF BOM
INSTR 3/68 DATED
231800Z APR 68

1 ATF Comd Net Fwd (VHF)

Refs: A. 1 ATF 30X Item No 6 - Apr 68.
 B. 1 ATF 30X Item No 15 - May 68.

Freq Date

<u>Freq</u> (MHz)	<u>Callword</u>	<u>Purpose</u>	<u>Effective</u>
51.35	EASY DOG	Comd Pri	Apr 68
38.45	BLOCK BUSTER	Comd Alt	
68.40	----	Retrans Pri	
58.15	----	Retrans Alt	
56.35	TO	Comd Pri	010001 May 68
51.35	HI	Comd Alt	
74.95	----	Retrans Pri	
66.90	----	Retrans Alt	

Net Diagram

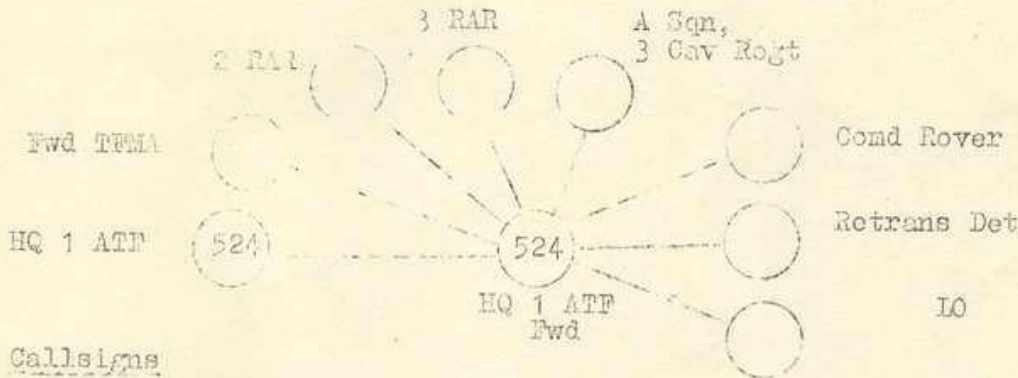

Callsigns

<u>STA</u>	<u>Call sign</u>	
	<u>Effective Apr 68</u>	<u>Effective 010001 May 68</u>
HQ 1 ATF Fwd (NCS)	16	19
HQ 1 ATF Rover	85	76
2 RAR	31	23
3 RAR	5	29
A Sqn 3 Cav Regt	42	51
Comd Rover	55	66
Retrans	37	81
Spare 1	61	8
IO	14	21
IO	15	22

ANNEX C TO 1 ATF SIG
INSTR 3/68 DATED
231800H APR 68

1 ATF COMD NET REAR (VHF)

- Refs: A. 1 ATF SOI Item No 8 - Apr 68.
B. 1 ATF SOI Item No 15 - May 68.

1. Freq Data:

<u>Freq</u>	<u>Callword</u>	<u>Purpose</u>	<u>Effective</u>
51.30	TP	Comd Pri	Apr 68
60.90	TR	Comd Alt	
75.95	ZY	Comd Pri	010001 May 68
58.25	QF	Comd Alt	

2. Net Diag:

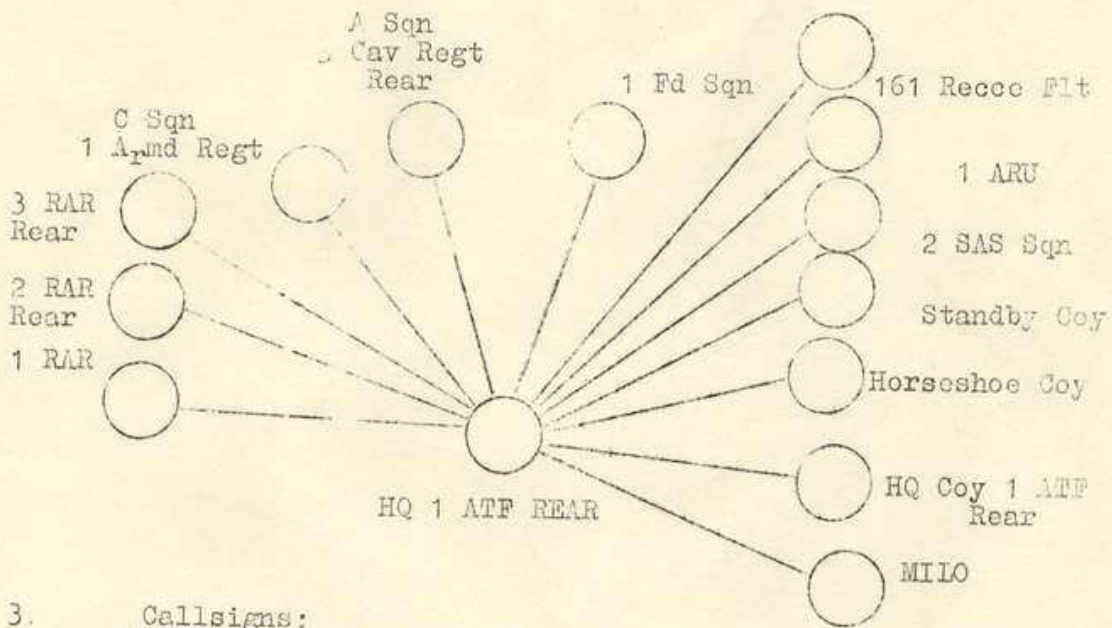

3. Callsigns:

<u>STA</u>	<u>Callsign</u>	
	<u>Effective Apr 68</u>	<u>Effective 010001 May</u>
HQ 1 ATF Rear (NCS)	85	76
1 RAR	25	54
2 RAR Rear	98	89
3 RAR Rear	34	3
C Sqn 1 Armd Regt Rear	93	33
A Sqn 3 Cav Regt Rear	88	61
1 Fd Sqn Rear	33	24
161 Recce Flt	91	17
1 ARU Rear	62	22
2 SAS Sqn Rear	53	84
Standby Coy Rear	71	35
Horseshoe Coy Rear	21	95
HQ Coy 1 ATF Rear	2	10
IO	10	72

CONFIDENTIAL

ANNEX D TO 1 ATF SIG
INSTR 3/68 DATED
231800H APR 68

MISC RADIO NETS

1. 1 ATF TG link 1 (HF Back-up)

<u>Freq</u>	<u>Callword</u>	<u>Purpose</u>	<u>Effective</u>
3675		Pri Opening Freq	From 240800 Apr
2056	JI	Alt ni freq	From 240800 Apr
9319		Alt day freq	From 240800 Apr

1 ATF Fwd

1 ATF Rear

2. Air Task Net

<u>Freq</u>	<u>Callword</u>	<u>Purpose</u>
32.30	ATOLL	RAAF Ops Rear
32.30	ATOLL 2	RAAF Ops Fwd
32.30	EAGLE HEIGHTS	1 ATF Air Rear
32.30	EAGLE HEIGHTS 2	1 ATF Air Fwd
32.30	JADE CONTROL	USAF IO (Rear)
32.30	TAC AIR	TAC AIR Common

3. Unit Nets. No change from APR/MAY 1 ATF SOIs.

4. Higher Pnn Nets. Ref II F Force V SOIs, Items Nos 51-6.

CONFIDENTIAL

CONFIDENTIAL

ANNEX E TO 1 ATF SIG
INSTR 3/68 DATED
231800H APR 68

RADIO RELAY CHANNEL ALLOCATION

1. US Sig Corps Det
G2 (Ops)/G2 Air to HURRICANE TOC
CP Fwd to HURRICANE TOC
ARTY TAG to HURRICANE TOC
EBONY FWD SWBD to HURRICANE TOC
EBONY FWD SWBD to PLANTATION

2. 110 SIG SQN
CP Fwd to CP Rear
A/Q Fwd to DACMG Rear
EBONY Fwd Swbd to EBONY Swbd
EBONY Fwd Swbd to EBONY Swbd
G2 Air to Air 1 ATF Rear
G2 Int to Int 1 ATF Rear
RTT Fwd Sigcen to Rear Sigcen (Secure)
Sigcen Supvr Fwd to Sigcen Supvr Rear

NOTE 1:

Separate channels to be provided to G2 (Ops) and G2 (Air) if and when further US Army Channels are made available.

CONFIDENTIAL

CONFIDENTIAL

ANNEX F TO 1 ATF SIG
INSTR 3/68 DATED
231800H APR 68

TELEPHONE DIRECTORY - 1 ATF MAIN

<u>EBONY FWD</u>	<u>SWBD EXTENSIONS</u>	<u>EBONY FWD TRUNKS</u>
G2 (OPS)	1	EBONY
ARTY TAC	2	HURRICANE TOC
SIGCEN	3	PLANTATION
COMMS CON	4	RAMROD
G2 AIR	6	RELIABLE (from 281200H)
CP	7	CASSANOVA
G2 (INT)	8	ENTERPRISE FWD
RAAF OPS	10	
USAF OPS	11	<u>BEARCAT AUTO SWBD</u>
DET 1 DIV INT UNIT	12	CP 2443
DAQMG	14	ARTY TAC 2754
REGISTRY	16	COMM CON 2448
3 RAR ECH	17	DAQMG/OC HQ COY 2226
2 RAR ECH	18	G2 OPS 2445
HQ COY	19	
RAP	20	<u>HURRICANE TOC</u>
TFMA	25	G2 OPS/G2 AIR 15
TFMA	26	EBONY FWD CP 25
TECH MAINT/A, Q		ARTY TAC 51
RR/HF DET		EBONY FWD SWBD 67
<u>DIRECT TELES</u>		
COMD	CP (Intercomm)	
G2 OPS QUARTERS	CP	
COMMS CON	VHF BUNKER	
COMMS CON	RR/HF BACK UP	
G2 AIR	RAAF READY ROOM ANTHILL PAD	
G2 AIR	161 RESCUE FLT	
COMMS CON	RADIO BUNKER	
COMMS CON	LINE RECORDS	

CONFIDENTIAL

ANNEX G TO 1 ATF SIG
INSTR 3/68 DATED
231800H APR 68

FWD TFMA AIR NET

Effective 010001H May 68.

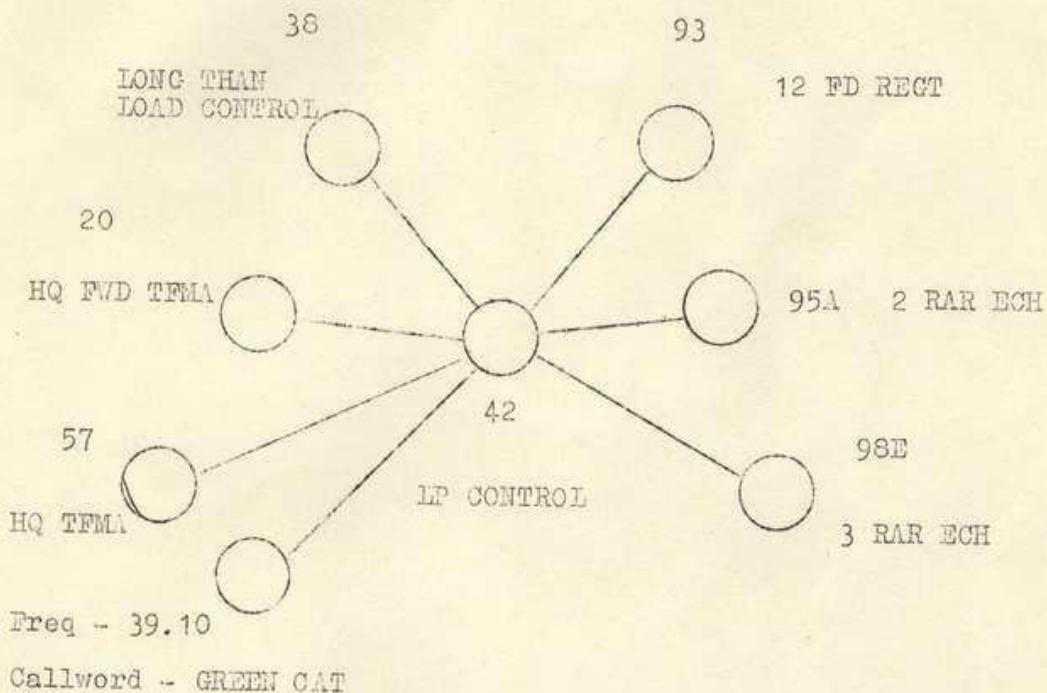

CONFIDENTIAL